

**REVISIONS:**

NO.	DATE	DESCRIPTION	BY

**NOT FOR CONSTRUCTION**

**SITE PLAN FOR SMJ OXFORD**  
 OXFORD, LAFAYETTE COUNTY, MISSISSIPPI

DRAWN BY:	J.W.	07.07.2023
CHECKED BY:	P.K.	AS NOTED
PROJECT NO.:	22156	

ALL ENGINEERING DRAWINGS ARE IN CONFIDENCE AND DISSEMINATION MAY NOT BE MADE WITHOUT PRIOR WRITTEN CONSENT OF THE ENGINEER. ALL COMMON LAW RIGHTS OF COPYRIGHT AND OTHERWISE ARE HEREBY SPECIFICALLY RESERVED.

PAGE NO.: **C104**

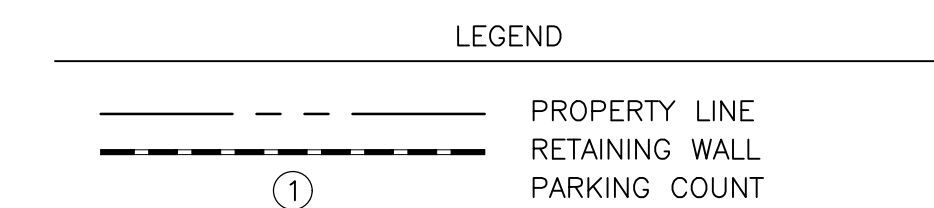

**SITE DATA**  
 ZONING: NEIGHBORHOOD RESIDENTIAL DISTRICT

**SETBACKS:**  
 FRONT YARD BUILD-TO LINE = 10 FEET/20 FEET (MIN./MAX.)  
 SIDE YARD SETBACK LINE (DETACHED) = 10 FEET  
 SIDE YARD SETBACK LINE (TOWNHOUSES) = 0 FEET  
 REAR YARD SETBACK LINE (DETACHED) = 25 FEET  
 REAR YARD SETBACK LINE (TOWNHOUSE) = 30 FEET

**BUILDING A-1 (6 ATTACHED; 3 BEDROOM TOWNHOUSES)**  
 TOTAL BUILDINGS = 3 BUILDINGS  
 TOTAL UNITS = 18 UNITS  
 TOTAL BEDS = 54 BEDS

**BUILDING A-2 (4 ATTACHED; 3 BEDROOM TOWNHOUSES)**  
 TOTAL BUILDINGS = 3 BUILDINGS  
 TOTAL UNITS = 12 UNITS  
 TOTAL BEDS = 36 BEDS

MINIMUM REQUIRED PARKING = 70 SPACES  
 MAXIMUM PARKING ALLOWED = 88 SPACES  
 PARKING PROVIDED = 82 SPACES

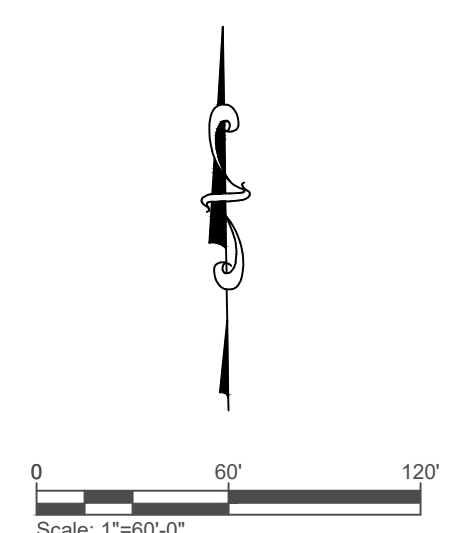
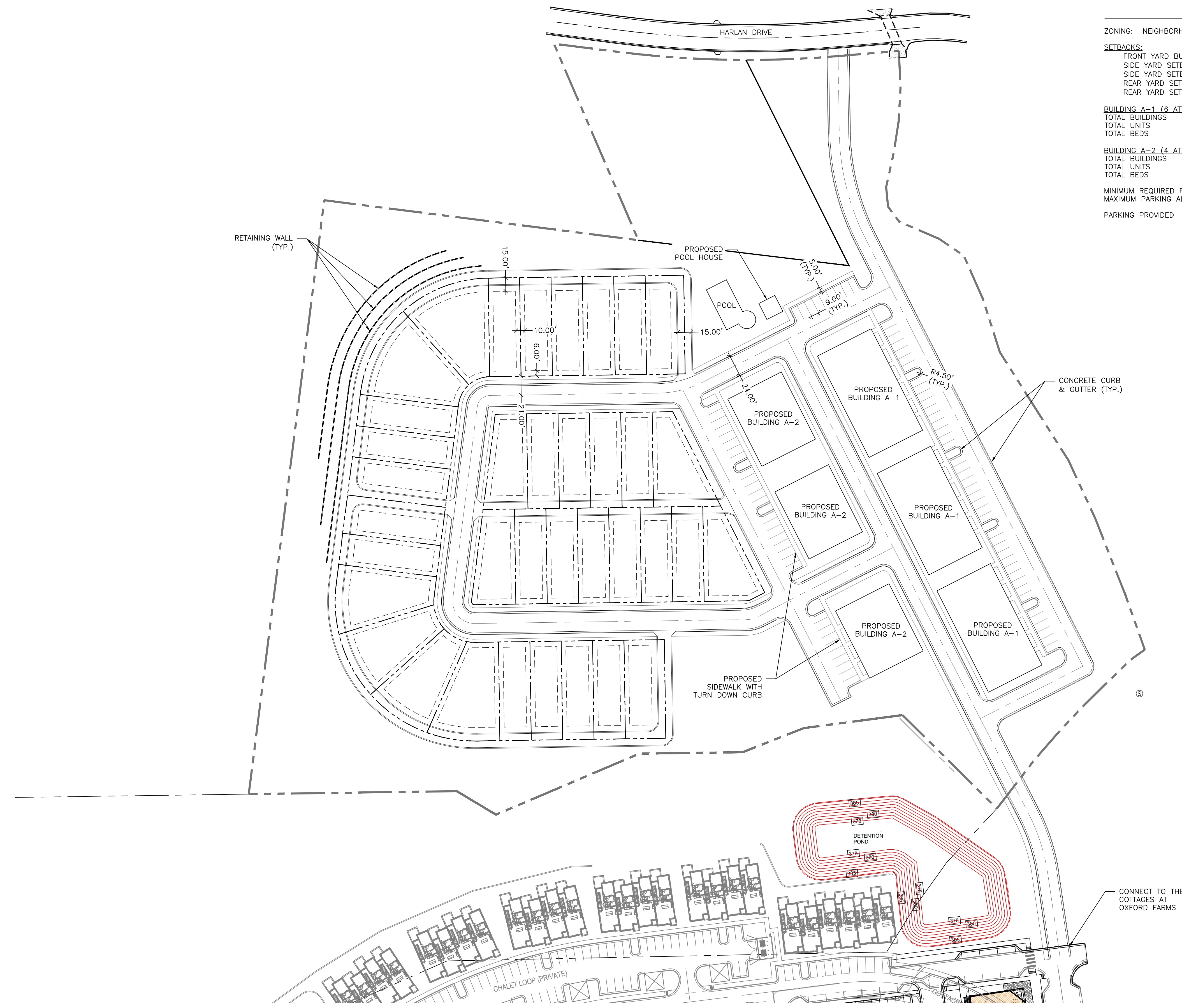

**1 SITE PLAN**  
 SCALE: 1"=60'

E:\22156\_Fitch\_Property\_Lamar\CAD\CAD\SHEET-4\_SITE.dwg SAVE: 7/11/2023 3:58 PM PLOT: 7/13/2023 1:26 PM